

GENERAL DEMOLITION NOTES

1. PROVIDE ALL LABOR, EQUIPMENT AND MATERIALS AS REQUIRED FOR THE COMPLETE DEMOLITION AND REMOVAL OF THE FOLLOWING BUILDING SYSTEMS AND POWER SYSTEMS; REMOVE EXISTING SECURITY LIGHTS ON THE ROOF.
2. DEMOLITION WORK OF BUILDING OUTSIDE LIGHTING FIXTURES SHALL INCLUDE BUT NOT LIMITED TO THE DISCONNECTION AND REMOVAL OF DEVICES BACK BOXES, EXPOSED PULL BOXES AND RACEWAY AND ALL WIRING FROM DEVICE.
3. THE DEMOLITION WORK SHALL BE CARRIED ON IN EVERY RESPECT IN A THOROUGH AND WORKMANLIKE MANNER.
4. ALL DEMOLITION, REMOVAL, AND DISPOSAL WORK SHALL BE IN COMPLIANCE WITH THE REQUIREMENTS OF THE BUILDING CODE OF THE CITY OF NEW YORK AND WITH ALL STATE AND FEDERAL REGULATIONS.
5. REMOVE ALL DEBRIS NOT EXPLICITLY DESIGNATED TO BE SALVAGED (TO REMAIN) FROM THE PREMISES AND LEGALLY DISPOSE OFF AWAY FROM PREMISES.
6. ITEMS INDICATED TO BE SALVAGED SHALL BE REMOVED EITHER BEFORE DEMOLITION OR DURING THE PROCESS OF THE WORK, STORED AND PROTECTED ON THE SITE IN A LOCATION DESIGNATED BY THE AUTHORITY'S REPRESENTATIVE. THESE ITEMS WILL BE IDENTIFIED AND RETAINED BY THE AUTHORITY.
7. CAREFULLY REMOVE AND PROTECT ALL ITEMS TO BE SAVED AND REUSED AS INDICATED ON DRAWINGS. REPLACE ANY ITEMS THAT ARE DAMAGED BY REMOVAL AT YOUR OWN COST. NOTIFY THE AUTHORITY IN WRITING OF ANY ITEM THAT IS DAMAGED PRIOR TO REMOVAL SO THAT THEY MAY ASCERTAIN THE ITEM'S CONDITION.
8. PROTECT MATERIALS, SURFACES AND STRUCTURE, WHICH ARE TO REMAIN, FROM DAMAGE; IF DAMAGE OCCURS, REPAIR OR REPLACEMENT SHALL BE MADE BY THE CONTRACTOR, TO THE SATISFACTION OF THE AUTHORITY, AND AT THE EXPENSE OF THE CONTRACTOR.
9. MAINTAIN CONTINUITY FOR ALL EQUIPMENT TO REMAIN. PROVIDE ALL REQUIRED ACCESSORIES, WIRING AND CONDUIT AS REQUIRED.
10. RELOCATE AND/OR ALTER THE EXISTING BUILDING COMPONENTS AS DIRECTED BY AUTHORITY'S REPRESENTATIVE. ALL RELOCATION OR ALTERATIONS TO BUILDING SHALL BE RESTORED TO THEIR ORIGINAL WORKING CONDITIONS AFTER SUCH RELOCATION OR ALTERATION WORK.
11. COORDINATE WITH SITE PERSONNEL TO MINIMIZE IMPACT OF OPERATION OF THE SCHOOL DURING DEMOLITION AND CONSTRUCTION.
12. SAFEGUARD ALL REMOVED ITEMS AND DISPOSE OF AS DIRECTED BY SCA PROJECT OFFICER.
13. AT THE COMPLETION OF DEMOLITION WORK, ALL RUBBISH, DEBRIS AND WASTE MATERIALS SHALL BE REMOVED BY THE CONTRACTOR AND THE PREMISES SHALL BE LEFT IN CLEAN CONDITION.
14. THE CONTRACTOR SHALL DISCONNECT THE CIRCUIT WIRING NOT IN USE AND SHALL REMOVE ALL NECESSARY WIRING MATERIALS, INCLUDING EXPOSED CONDUITS AND JUNCTION BOXES WHICH IMPEDE THE NEW WORK.
15. SUBSTANTIAL JOB COMPLETION INCORPORATES DEMOLITION OF EXISTING SYSTEMS IN CONTRACT.
16. PROVIDE TEMPORARY LIGHTING DURING EXTERIOR MODIFICATION WORK.

GENERAL NOTES

1. ALL WORK SHALL BE PERFORMED IN STRICT ACCORDANCE WITH THE REQUIREMENTS OF THE 2008 NATIONAL ELECTRICAL CODE (NEC), THE NEW YORK CITY ELECTRICAL CODE AMENDMENTS, THE APPLICABLE SECTIONS OF THE NFPA, THE NEW YORK CITY BUILDING CODE, THE NYCSCA, THE DOE, AND ALL GOVERNING LOCAL CODES, LAWS, AND REGULATIONS.
2. PROVIDE A COMPLETE OPERABLE SYSTEM IN A WORKMANLIKE MANNER. OUTLINE DESCRIPTION AND EQUIPMENT DO NOT LIMIT CONTRACTOR'S LIABILITY FOR THE INSTALLATION OF A COMPLETE OPERABLE SYSTEM. SCOPE OF WORK:
 - WORK ASSOCIATED WITH MECHANICAL EQUIPMENT REPLACEMENT/MODIFICATION.
 - EXTERIOR LIGHTING FIXTURE MODIFICATION.
3. ALL WORK SHOWN ON THE DRAWINGS NOT SPECIFICALLY CALLED OUT AS EXISTING SHALL BE CONSIDERED WORK TO BE PERFORMED UNDER THIS CONTRACT.
4. OBTAIN ALL ELECTRICAL PERMITS, TEST REPORTS, CERTIFICATIONS FOR T.C.O. AND C.O.
5. MINIMUM SIZE OF CONDUITS SHALL BE 3/4", UNLESS OTHERWISE NOTED.
6. NO CONDUIT SHALL BE RUN IN ANY FLOOR IN CONTACT WITH THE EARTH UNLESS OTHERWISE DIRECTED ON THE PLANS.
7. CONDUIT RUNS IN CORRIDORS SHALL CLEAR ALL ARCHITECTURAL FEATURES (DOORS, WINDOWS, ETC) AND SHALL BE COORDINATED WITH EXISTING OR NEW EQUIPMENT, PIPING AND DUCT WORK CORRESPONDING TO ALL TRADES INCLUDING BUT NOT LIMITED TO MECHANICAL, PLUMBING, FIRE PROTECTION AND ELECTRICAL TRADES. NOTIFY THE ENGINEER OF ANY OBSTRUCTION BEFORE INSTALLATION. FAILURE TO COMPLY WITH THIS REQUIREMENT WILL NOT BE CONSIDERED ADDITIONAL WORK AND SHALL BE CORRECTED AT NO ADDITIONAL COST TO THE OWNER.
8. IN UNFINISHED PORTIONS OF BUILDING SUCH AS BOILER ROOM, FAN ROOMS, PIPE SPACES, ETC., LOCATIONS OF CONDUIT AND SYSTEM DEVICES ARE APPROXIMATE AND SHALL CLEAR PIPING AND ALL OTHER CONSTRUCTION. ALL SYSTEM DEVICES MUST BE UNOBSERVED AND SHALL CLEAR ANY INTERFERENCE WITH FIXTURES, PIPING EQUIPMENT, ETC.
9. RACEWAY INSTALLED EXPOSED ON THE SURFACE OF CEILINGS OR SIDEWALLS SHALL BE SUPPORTED FROM STRUCTURAL COMPONENTS OF THE BUILDING.
10. ALL RACEWAYS AND CABINETS SHALL BE GROUNDED TO THE BUILDING GROUNDING SYSTEM WITH AN INSULATED GROUND CONDUCTOR NOT SMALLER THAN #10 U.O.N.
11. UNLESS OTHERWISE NOTED, PULL BOXES, JUNCTION BOXES, AND ELECTRICAL EQUIPMENT INCLUDING BUT NOT LIMITED TO PANELS, LOW VOLTAGE SYSTEMS DEVICES, ETC. WHERE INDICATED ON DRAWINGS, SHALL BE CONSIDERED SHOWN AT THEIR APPROXIMATE LOCATION. THE CONTRACTOR SHALL LOCATE THEM AS FIELD CONDITIONS DICTATE. ADDITIONAL PULL AND JUNCTION BOXES NOT SHOWN ON DRAWINGS SHALL BE PROVIDED WHERE REQUIRED BY APPLICABLE CODE PROVISIONS OR WHERE CALLED FOR BY FIELD CONDITIONS.
12. ALL RACEWAY RUNS ARE SHOWN DIAGRAMMATICALLY TO OUTLINE THE GENERAL ROUTING OF MAJOR FEEDERS. THE INSTALLATION SHALL BE MADE TO AVOID INTERFERENCE WITH PIPES, DUCTS, STRUCTURAL MEMBERS OR OTHER EQUIPMENT. SHALL ANY OF THIS ELEMENTS PREVENT THE INSTALLATION OF RACEWAY AS DELINEATED ON THIS DRAWING, DEVIATION MUST BE APPROVED BY THE ENGINEER PRIOR TO INSTALLATION. ANY VARIATION DUE TO FIELD CONDITIONS SHALL NOT REPRESENT AN ADDITIONAL COST TO OWNER.
13. ALL ELECTRICAL EQUIPMENT AND RACEWAY SHALL BE SUSPENDED FROM SUPPLEMENTAL SLOTTED CHANNEL FRAME. ALL SUCH MOUNTS, DEVICES, FASTENERS SHALL BE OF SUFFICIENT THICKNESS TO CARRY THE LOAD SUSPENDED AND CONTRACTOR SHALL BE RESPONSIBLE FOR PROVIDING ANY ADDITIONAL SUPPLEMENTAL STEEL REQUIRED TO SUPPORT THE EQUIPMENT OR DEVICES.
14. ALL OPENINGS BETWEEN FLOORS, THROUGH RATED FIRE AND SMOKE WALLS, CREATED BY THE CONTRACTOR FOR CABLE OR CONDUIT PASS THROUGH SHALL BE SEALED WITH A FIRE STOPPING MATERIAL. FIRE STOPPING MATERIAL AND ITS APPLICATION SHALL BE ACCOMPLISHED IN SUCH A MANNER THAT IS ACCEPTABLE TO THE LOCAL FIRE AND BUILDING AUTHORITIES HAVING JURISDICTION OVER THIS WORK. ANY OPENINGS CREATED BY OR FOR THE CONTRACTOR AND LEFT UNUSED SHALL ALSO BE SEALED AS PART OF THIS WORK.
15. CONTRACTOR TO BE RESPONSIBLE FOR ALL RESTORATIONS, SEALING, WATERPROOFING, PENETRATIONS, CORE DRILLING CUTTING, PATCHING, AND PAINTING FOR THE COMPLETE CONTRACT WORK INDICATED. ALL RESTORATION WORK PERFORMED BY CONTRACTOR SHALL RESTORE DISTURBED SURFACES TO THEIR ORIGINAL CONDITION.
16. ARCHITECTURAL FEATURES AS WELL AS OTHER TRADES EQUIPMENT SHOWN ON ELECTRICAL DRAWINGS ARE FOR BACKGROUND INFORMATION ONLY.

GENERAL NOTES (CONT.)

19. ALL EXPOSED NONCURRENT-CARRYING METAL PARTS OF ELECTRICAL EQUIPMENT AND RACEWAYS SHALL BE GROUNDED. FOR FEEDERS AND/OR BRANCH CIRCUITS WHERE GROUNDING CONDUCTOR IS NOT PROVIDED, METAL RACEWAYS AND METAL ENCLOSURES FOR CONDUCTORS SHALL BE TIGHTLY JOINED TO CREATE A CONTINUOUS ELECTRIC CIRCUIT AND SO ASSURE A PROPERLY GROUNDED SYSTEM. FITTINGS FOR JOINTS AND TERMINATIONS SHALL BE LISTED FOR GROUNDING INSTALLATION. PROVIDE BONDING JUMPERS WITH APPROVED FITTINGS OF SIZE REQUIRED FOR EQUIPMENT GROUNDING. THE CONTRACTOR SHALL ENSURE CONTINUITY OF THE GROUNDING CIRCUIT FROM THE SUPPLYING PANELBOARD GROUNDING BUS TO THE LOAD GROUND TERMINAL.
20. ALL DEVICES AND ACCESSORIES INSTALLED OUTSIDE OR EXPOSED TO WEATHER SHALL HAVE WEATHER PROOF ENCLOSURES AND SHALL BE TIGHTLY GASKETED FOR A COMPLETE RAINTIGHT INSTALLATION.
21. REMOVE ALL DEBRIS RESULTING FROM REMOVAL OF ELECTRICAL WORK FROM THE PREMISES.
22. ANY EXISTING WORK DAMAGED AS A RESULT OF PERFORMING THE WORK OF THIS CONTRACT SHALL BE REPAIRED OR REPLACED AS REQUIRED AT NO ADDITIONAL COST TO THE OWNER. MATERIAL AND FINISH TO MATCH EXISTING TO THE SATISFACTION OF OWNER.
23. TEST ALL DEVICES BEING RELOCATED/REINSTALLED PRIOR TO PERFORMING WORK AND AFTER RELOCATION/REINSTALLATION. TESTING SHALL BE DONE IN THE PRESENCE OF SCA PROJECT OFFICER AND SCHOOL DESIGNEE. PROVIDE FUNCTIONALITY REPORT (FOR EACH TEST) TO SCA, SCHOOL AND EOR FOR RECORD PURPOSE.

ABBREVIATIONS

SYMBOL	DESCRIPTION
A	AMPS
AC	AMPERE
AC	ALTERNATING CURRENT
AFF	ABOVE FINISHED FLOOR
ARCH	ARCHITECTURAL
AWG	AMERICAN WIRE GAUGE
C	CONDUIT
CAT	CATEGORY
CKT	CIRCUIT
CLG	CEILING
CONST	CONSTRUCTION
COL	COLUMN
CU	COPPER
CUST	CUSTODIAN
DISC	DISCONNECT
DOE	DEPARTMENT OF EDUCATION
DWG	DRAWING
EC	EMPTY CONDUIT
ELEC	ELECTRIC
EMT	ELECTRIC METALLIC TUBING
ER	EXISTING TO REMAIN
ETC	ETCETERAS
ETR	EXISTING TO BE RELOCATED/REINSTALLED
EXIST	EXISTING
FL	FLOOR
G. GND	GROUND
H	HEIGHT
JB	JUNCTION BOX
MIN	MINIMUM
MTD	MOUNTED
N	NEUTRAL
NEC	NATIONAL ELECTRICAL CODE
NFPA	NATIONAL FIRE PROTECTION ASSOCIATION
No	NUMBER
NTS	NOT TO SCALE
P	POLE
PB	PULL BOX
PNL	PANEL
RGS	RIGID GALVANIZED STEEL CONDUIT
RL	RELOCATED
RM	ROOM
SP	SPARE
STD	STANDARD
TPY	TYPICAL
UON	UNLESS OTHERWISE NOTED
V	VOLT
W	WATT, WIRE, WIDTH
WP	WEATHERPROOF

LIGHTING & POWER SYMBOLS

SYMBOL	DESCRIPTION
SYMBOLS SHOWN WITH DARK SOLID LINES INDICATES NEW WORK IN CONTRACT	
SYMBOLS SHOWN WITH LIGHT DASHED LINES AND SUBSCRIPT 'ER' INDICATES EXISTING TO REMAIN. 'ETR' INDICATES EXISTING TO RELOCATE. 'RL' INDICATES RELOCATED.	
SYMBOLS SHOWN WITH DARK DASHED LINES - INDICATES DEMOLITION WORK IN CONTRACT	
HOME RUN-NOTATION INDICATES PANEL AND CIRCUIT NUMBER. No. OF ARROWS DENOTES No. OF CIRCUITS 2#12 IN 3/4". IS MINIMUM FEEDER TO BE PROVIDED (U.O.N.). NUMBER OF TICKS INDICATES QUANTITY OF #12 AWG WIRES (U.O.N.). GROUND WIRE IS NOT INCLUDED IN TICK MARKS AND MUST BE PROVIDED FOR ALL BRANCH CIRCUITS.	
	JUNCTION BOX AND FINAL CONNECTION
	TIME CLOCK
	PULL BOX
	POWER PANELBOARD. SURFACE MOUNTED
	30A RATED, 240V, 3 POLE UNFUSED SWITCH/MAGNETIC STARTER COMBINATION IN NEMA TYPE 1 ENCLOSURE (UON) WITH 208/120V OVERSIZED CONTROL POWER TRANSFORMER (CPT) "HAND-OFF-AUTO" MAINTAINED CONTACT SELECTOR SWITCH AND RUNNING GREEN PILOT LIGHT. STARTER NEMA SIZE 1, '60' INDICATES 60A SWITCH RATING.
	240V UNFUSED DISCONNECT SWITCH IN NEMA TYPE 1 ENCLOSURE (UON). '3R' INDICATES IN NEMA TYPE 3R ENCLOSURE. '30/3' INDICATES 30A, 3 POLE, 'WP' INDICATED IN WEATHERPROOF ENCLOSURE.
	ELECTRIC MOTOR, NUMBER INDICATES HORSE POWER RATING
	PARAPET MOUNTED EXTERIOR LIGHTING FIXTURE
	NYPD ANTENNA HEAD END CABINET

President & CEO
Lorraine Grillo



Board of Trustees
Chancellor Richard A. Carranza, Chairman
Curtis A. Harris
Emily A. Youssouf

Architecture & Engineering

E. Bruce Barrett, R.A. LEED A.P., Vice President
Elan R. Abneri, P.E., Senior Director, Design Consultant Management
Stanley Dahir, R.A., Sr. Director, Quality Control & Construction Support
María A. Gómez, P.E., LEED A.P., Senior Director, A&E In-House Design
George D. Roussey, P.E., LEED A.P., Director, Technical Standards
Stacey Spann-Thom, Director, Operations Support

Consultants:



32 AVENUE OF THE AMERICAS
NEW YORK, NY 10013
TEL 212 505 1133
FAX 212 505 1726

SHENOY ENGINEERING
30 108 AVE, SUITE 102, FREDONIA, NJ 07098
T: 973.691.0001 F: 973.691.0002

NOTE: Drawing may be printed at reduced scale

IT IS A VIOLATION OF THE STATE EDUCATION LAW SECTION 7209 (2) FOR ANY PERSON TO ALTER AN ITEM IN ANY WAY UNLESS SUCH PERSON IS ACTING UNDER THE DIRECTION OF A LICENSED PROFESSIONAL ENGINEER, AND THE ENGINEER STAMPS SUCH CHANGES

No.	Date	Revision

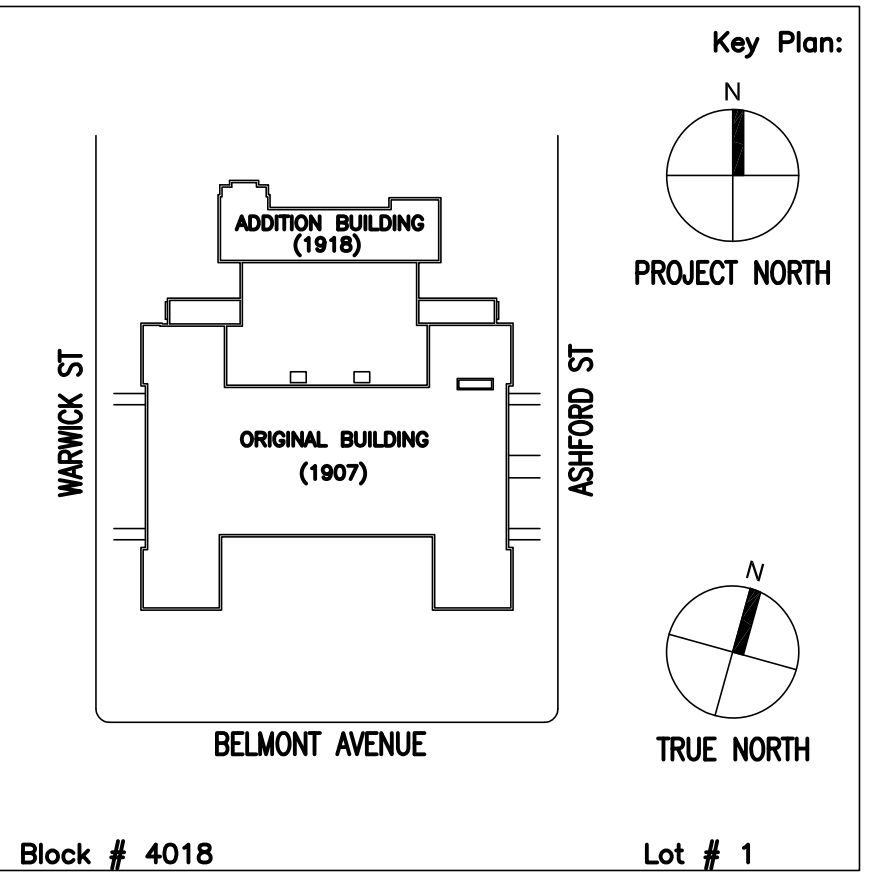

SCA Design Manager: WILLIAM DONG		
Project Architect/Engineer: DAVID MAY, RA		
Discipline Lead:	YATISH SHARMA, PE	
Designer:	CHARLES E HENKEL JR.	
Drawn by:	ANJOE INTAL	
Checked by:	RAVI SHENOY, PE	
Design No: D018779	Facility Code: K158	Date: 05/13/2019

Project:
**P.S. 158 – BROOKLYN
FLOOD ELIM., PARAPETS, WINDOWS,
PAVED AREAS, EXT. MASONRY, ROOFS**
Address:
400 ASHFORD STREET
BROOKLYN, NY 11207

Drawing Title:
ELECTRICAL NOTES, SYMBOL LIST,
AND ABBREVIATIONS

Reserved For
DOB NOW Job#

Drawing No.:	E001.00
Sheets in Contract Set:	62 of 90
Sheets in DOB Set:	— of 73