

**CELLAR ELECTRICAL CLOSET
NEW POWER PART PLAN**

SCALE: 1/4"=1'-0"

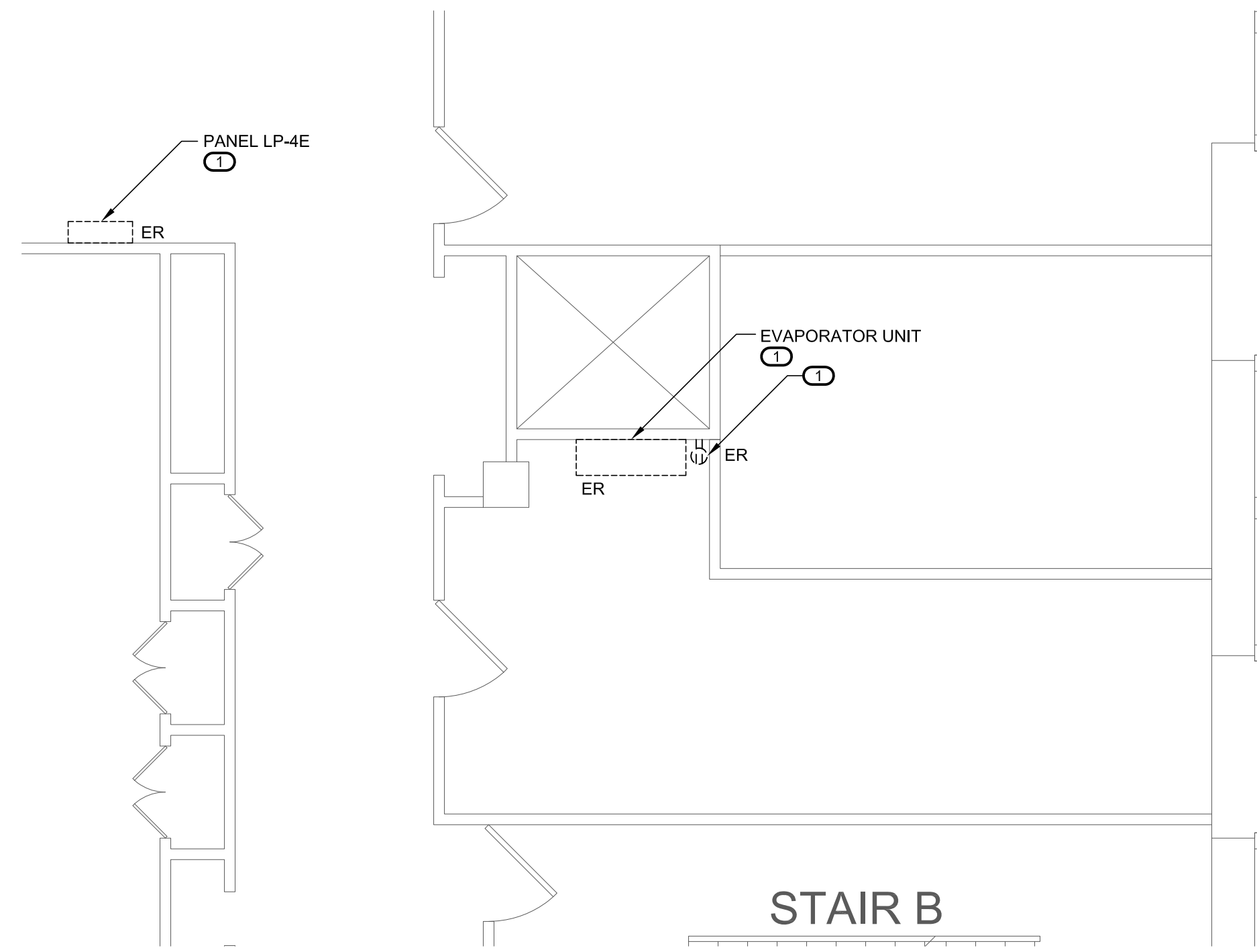
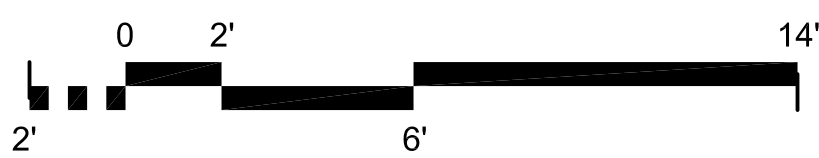

**FOURTH FLOOR MDF ROOM
DEMOLITION PART PLAN**

SCALE: 1/4"=1'-0"

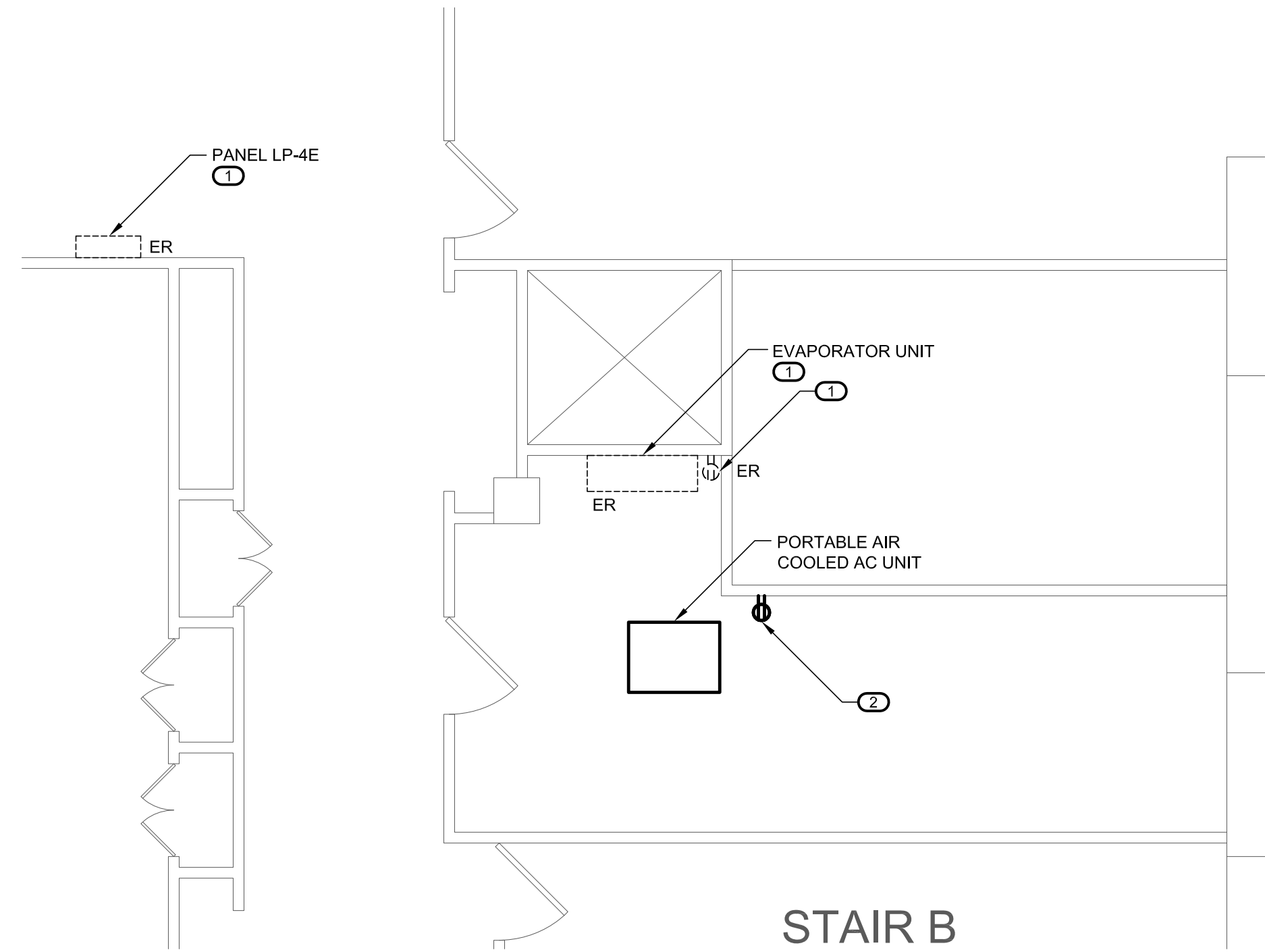
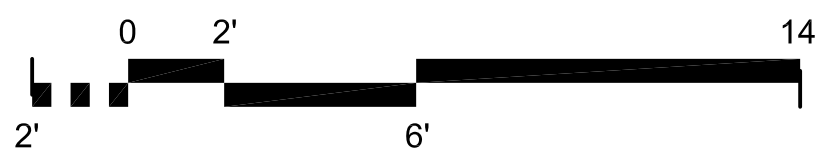

**BASEMENT FAN ROOM 071
NEW POWER PART PLAN**

SCALE: 1/4"=1'-0"

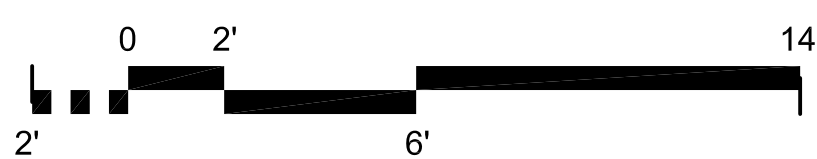

NOTES

- REFER TO DRAWING E001 FOR GENERAL NOTES, ABBREVIATIONS AND ELECTRICAL SYMBOLS LIST.
- ALL AREAS DISTURBED DUE TO CONSTRUCTION WORK SHALL BE PATCHED AND PAINTED TO MATCH EXISTING CONDITIONS. PROVIDE PAINTING OF ENTIRE WALL TO THE NEAREST CORNER.
- MAINTAIN CONTINUITY IN ALL EXISTING CIRCUITRY TO REMAIN WHICH IS AFFECTED BY THE SCOPE OF WORK. FURNISH AND INSTALL ALL REQUIRED WIRES, CONDUITS AND JUNCTION BOXES TO KEEP CONTINUITY.
- CONTRACTOR SHALL COORDINATE WITH THE GC REMOVING OF EQUIPMENT AND CONDUIT.
- EXISTING ELECTRICAL PANELS, EQUIPMENT, DEVICES, CONDUITS AND PULL BOXES TO REMAIN SHALL BE PROTECTED DURING DEMOLITION WORK.
- EXISTING DEVICES MARKED TO REMAIN SHALL BE PROTECTED DURING CONSTRUCTION WORK.
- REFER TO DRAWING E701 FOR ELECTRICAL DETAILS.
- TEST ALL DEVICES BEING RELOCATED/REINSTALLED PRIOR TO PERFORMING WORK AND AFTER RELOCATION/REINSTALLATION. TESTING SHALL BE DONE IN THE PRESENCE OF SCA PROJECT OFFICER AND SCHOOL DESIGNEE. PROVIDE FUNCTIONALITY REPORT (FOR EACH TEST) TO SCA, SCHOOL AND EOR FOR RECORD PURPOSE.

KEY NOTES

- EXISTING DEVICE/EQUIPMENT SHALL REMAIN AND BE PROTECTED THROUGHOUT CONSTRUCTION.
- PROVIDE RECEPTACLE FOR TEMPORARY AC UNIT AND CONDENSATE DRAIN PUMP. COORDINATE LOCATION AND TYPE OF RECEPTACLE WITH MECHANICAL CONTRACTOR PRIOR TO INSTALLATION. PROVIDE POWER FROM EXISTING PANEL LP-4E.
- PROVIDE TEMPORARY SUPPORT FOR MAIN GROUNDING BUS BAR. RE-SUPPORT MAIN GROUNDING BUS BAR AFTER REPAIR WORK IS COMPLETED.

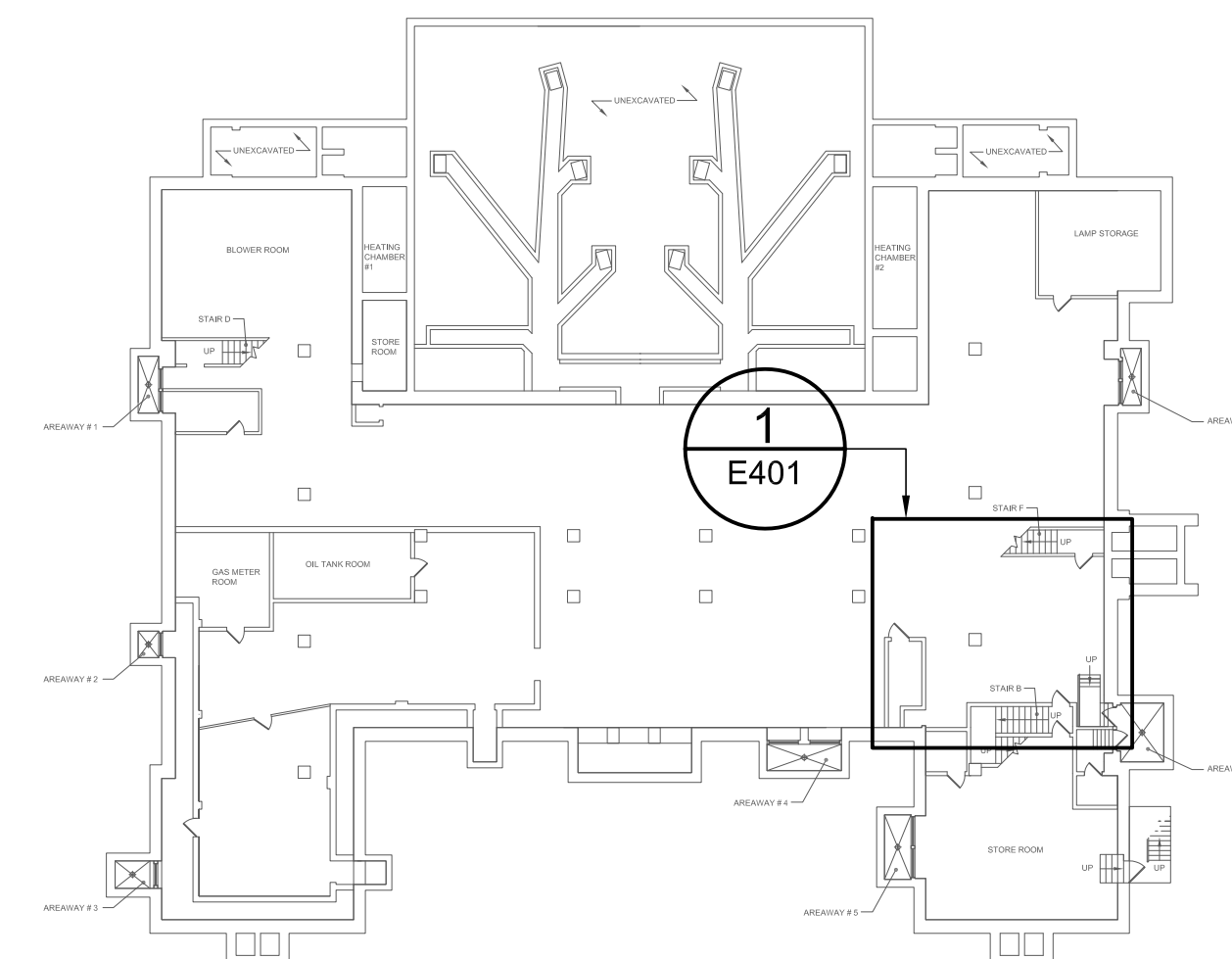

CELLAR KEY PLAN

SCALE: 1/32"=1'-0"

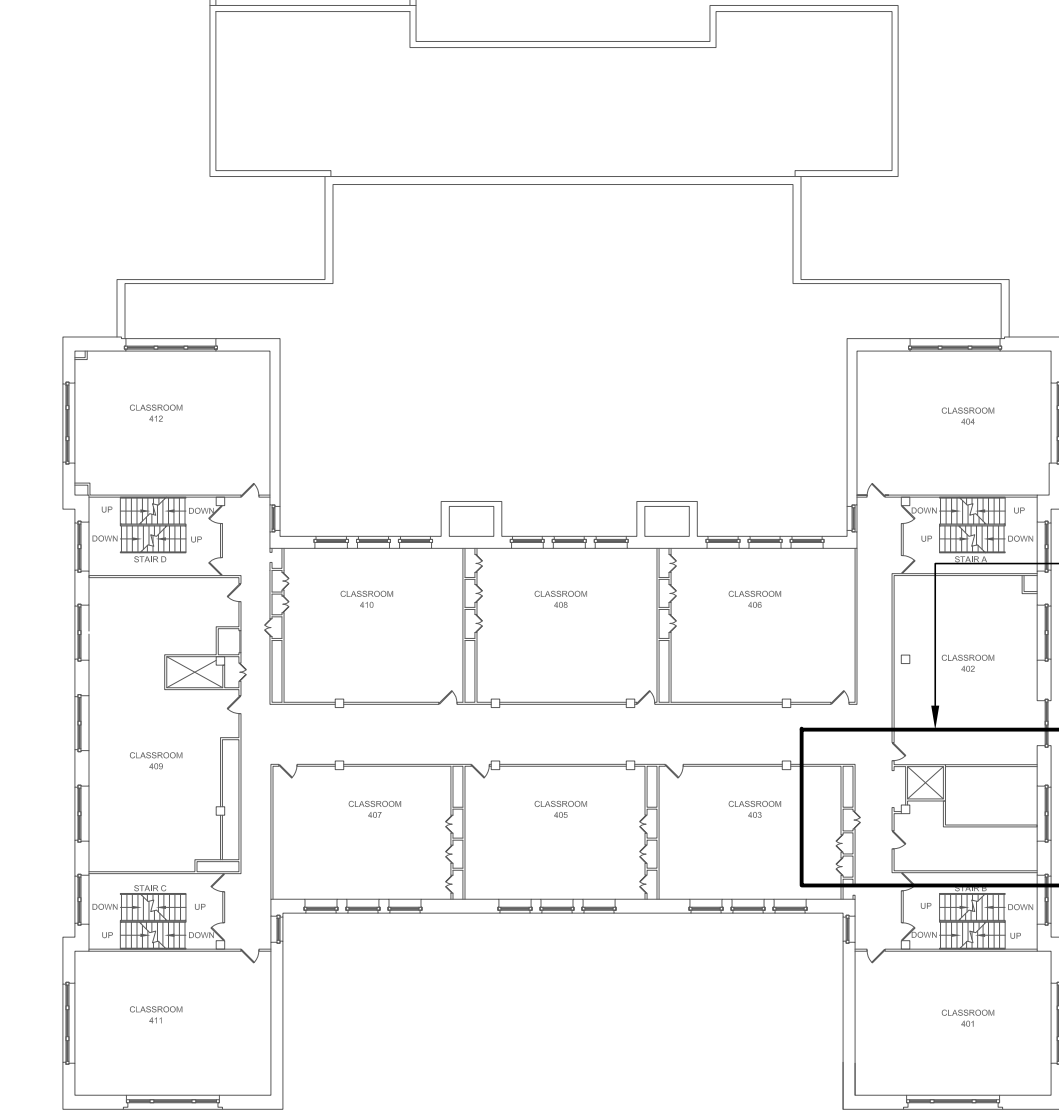
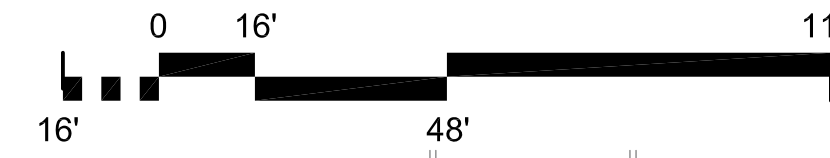

FOURTH FLOOR KEY PLAN

SCALE: 1/32"=1'-0"

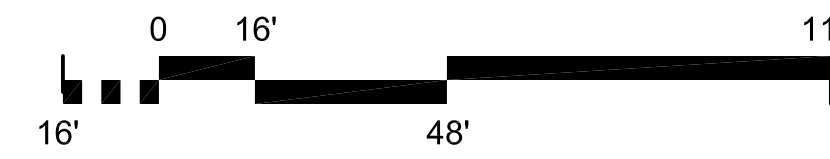

President & CEO
Lorraine Grillo

Board of Trustees

Chancellor Richard A. Carranza, Chairman
Curtis A. Harris
Emily A. Youssouf



Architecture & Engineering

E. Bruce Barrett, R.A. LEED A.P., Vice President
Elon R. Abneri, P.E., Senior Director, Design Consultant Management
Stanley Dahir, R.A., Sr. Director, Quality Control & Construction Support
María A. Gómez, P.E., LEED A.P., Senior Director, A/E In-House Design
George D. Roussey, P.E., LEED A.P., Director, Technical Standards
Stacey Spann-Thom, Director, Operations Support

Consultants:

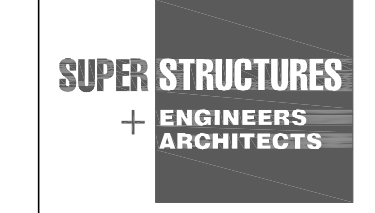

32 AVENUE OF THE AMERICAS
NEW YORK, NY 10013
TEL 212 505 1133
FAX 212 505 1726

NOTE: Drawing may be printed at reduced scale

IT IS A VIOLATION OF THE STATE EDUCATION LAW SECTION 7209 (2) FOR ANY PERSON TO ALTER AN ITEM IN ANY WAY UNLESS SUCH PERSON IS ACTING UNDER THE DIRECTION OF A LICENSED PROFESSIONAL ENGINEER, AND THE ENGINEER STAMPS SUCH CHANGES

No.	Date	Revision

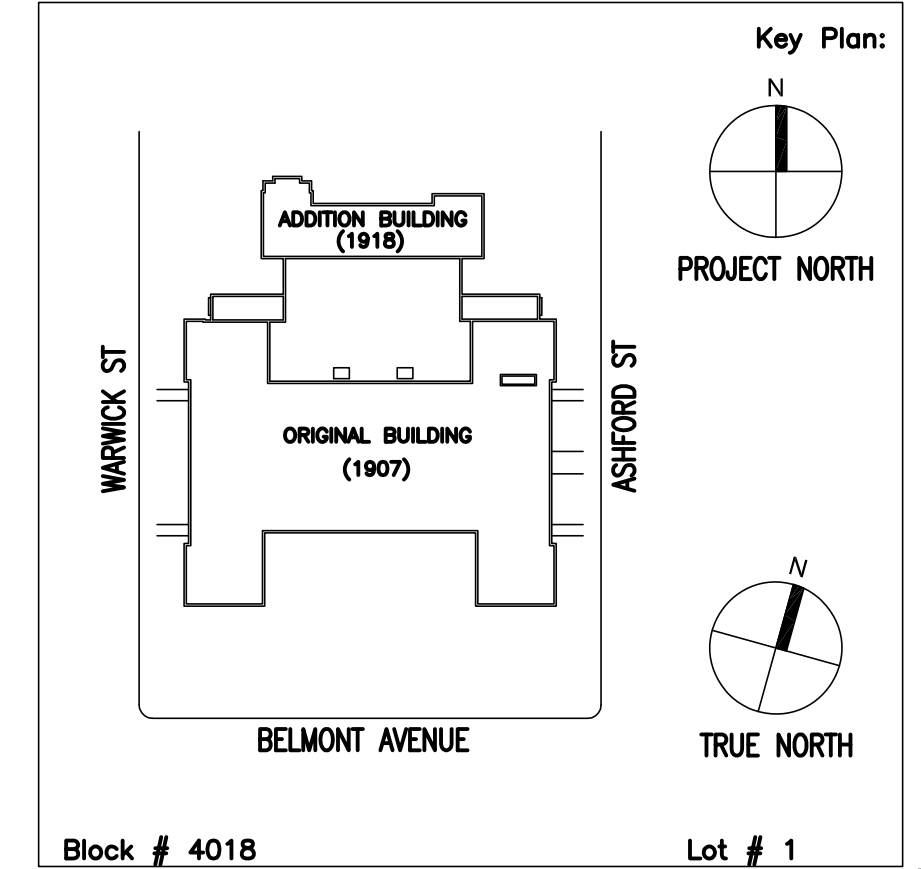

Block # 4018 Lot # 1

SCA Design Manager: WILLIAM DONG		
Project Architect/Engineer: DAVID MAY, RA		
Discipline Lead:	YATISH SHARMA, PE	
Designer:	CHARLES E HENKEL JR.	
Drawn by:	ANJOE INTAL	
Checked by:	RAVI SHENOY, PE	
Design No:	Facility Code:	Date:
D018779	K158	05/13/2019

Project:
**P.S. 158 - BROOKLYN
FLOOD ELIM., PARAPETS, WINDOWS,
PAVED AREAS, EXT. MASONRY, ROOFS**
Address:
400 ASHFORD STREET
BROOKLYN, NY 11207

Drawing Title:
PART PLANS

Reserved For
DOB NOW Job#

Drawing No.:	E401.00
Sheets in Contract Set:	69 of 90
Sheets in DOB Set:	— of 73

S:\Projects\17002_NYSCA_SCA\18_158K_Phropets, Windows, Flood_Elim\02_Drawings\06_Elec\E401_PART_PLANS.dwg 05/13/19 4:10pm Revoked