

GENERAL NOTES

- REFER TO DRAWING P001 FOR SYMBOLS, NOTES AND ABBREVIATIONS.
- REFER TO ARCHITECTURAL DRAWINGS FOR ALL ROOFING WORK. THE CONTRACTOR SHALL FIELD VERIFY EXISTING CONDITIONS
- THE CONTRACTOR SHALL PROVIDE CUTTING, PATCHING, RESTORATION AND FINISH PAINTING TO EXISTING CONSTRUCTION AND ALL DISTURBED AREAS DUE TO WORK IN THIS CONTRACT.
- MAINTAIN CONTINUITY OF SERVICES A AT ALL TIMES. DEMOLITION WORK SHALL BE EXECUTED BASED ON APPROVED WORK SCHEDULES
- CLEAN ALL STORM PIPING. SNAKE AND PRESSURE WASH PIPING FROM ROOF DRAIN DOWN TO STREET MAIN. TEST DRAIN PIPES BOTH AT START OF JOB IN THE PRESENCE OF THE SCA AUTHORITY, PRIOR TO STARTING CONSTRUCTION AND AFTER COMPLETION OF PROJECT. CONFIRM ALL ROOF DRAINS AND LINES ARE WORKING PROPERLY PRIOR TO SIGN-OFF.

KEY NOTES

- REMOVE EXISTING ROOF DRAIN ASSEMBLY AND ASSOCIATED CONNECTIONS TO EXISTING STORM PIPING BELOW.
REMOVE A MINIMUM OF 10'-0" AND/OR NOT LESS THAN THE FIRST ELBOW FROM EXISTING PIPING FROM THE NEW ROOF DRAIN LOCATION.
- REMOVE EXISTING VENT MIN. 10'-0" AND/OR NOT LESS THAN THE FIRST ELBOW.
- EXISTING ROOF VENTS TO REMAIN AND RE-FLASHED. PROTECT VENTS IN PLACE DURING ROOFING.

President & CEO
Lorraine Grillo

Board of Trustees
Chancellor Richard A. Carranza, Chairman
Curtis A. Harris
Emily A. Youssef

Architecture & Engineering
E. Bruce Barrett, R.A. LEED A.P., Vice President
Elon R. Abneri, P.E., Senior Director, Design Consultant Management
Stanley Dahir, R.A., Sr. Director, Quality Control & Construction Support
Maria A. Gomez, P.E., LEED A.P., Senior Director, A/E In-House Design
George D. Roussey, P.E., LEED A.P., Director, Technical Standards
Stacey Spann-Thom, Director, Operations Support

Consultants:

SUPER STRUCTURES
ENGINEERS ARCHITECTS

SHENY ENGINEERING
39 US AVE., SUITE 802 FREEHOLD, NJ 07728
TEL 212 505 1133
FAX 212 505 1728

32 AVENUE OF THE AMERICAS
NEW YORK, NY 10013
TEL 212 505 1133
FAX 212 505 1728

NOTE: Drawing may be printed at reduced scale

IT IS A VIOLATION OF THE STATE EDUCATION LAW SECTION 7209 (2) FOR ANY PERSON TO ALTER AN ITEM IN ANY WAY UNLESS SUCH PERSON IS ACTING UNDER THE DIRECTION OF A LICENSED PROFESSIONAL ENGINEER, AND THE ENGINEER STAMPS SUCH CHANGES

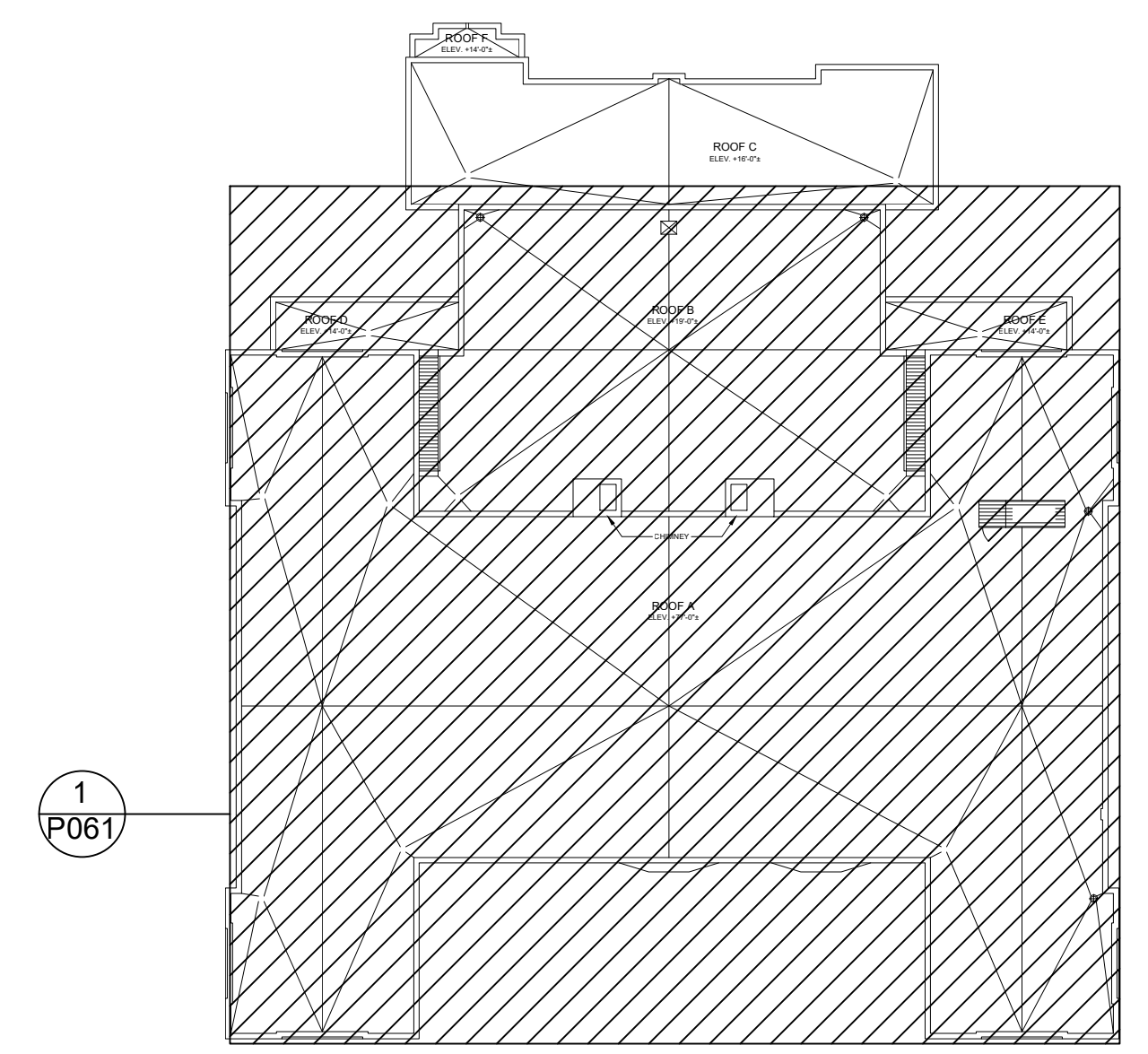

KEY PLAN - ROOF
NOT TO SCALE

No.	Date	Revision

Key Plan:
PROJECT NORTH
TRUE NORTH

WARWICK ST
ASHFORD ST
BELMONT AVENUE

Block # 4015 Lot # 1

SCA Design Manager: WILLIAM DONG		
Project Architect/Engineer: DAVID MAY, RA		
Discipline Lead: KAUSHAL TRIVEDI, PE		
Designer: JONATHAN CASINO		
Drawn by: GARRETT HARBESON		
Checked by: JOSE HONRADO		
Design No: D018779	Facility Code: K158	Date: 05/13/2019

Project:
P.S. 158 - BROOKLYN
FLOOD ELIM., PARAPETS, WINDOWS,
PAVED AREAS, EXT. MASONRY, ROOFS

Address:
400 ASHFORD STREET
BROOKLYN, NY 11207

Drawing Title:
**PLUMBING DEMOLITION ROOF
PART PLAN**

Reserved For
DOB NOW Job#

Drawing No.:	P061.00
Sheets in Contract Set:	78 of 90
Sheets in DOB Set:	70 of 73

PLUMBING DEMOLITION PART PLAN - ROOF

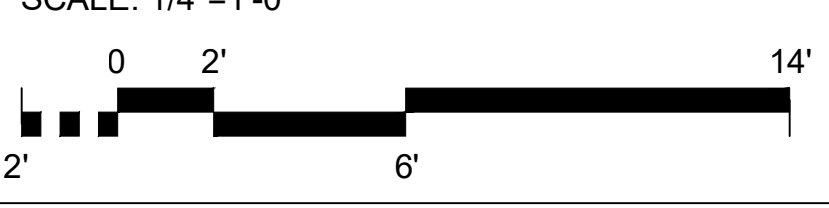

FID Job#: 0220-19
Number of drawings submitted: 73
Date Certified: 05/22/2019
SUBMITTED WITH SELF-CERTIFICATION OF
OBJECTIONS as per Department of Buildings
Technical RPN # 1/01

L:\59008A_5906001 CONTRACT DOCUMENTS\WP Drawings (dwg)\WP Drawings (dwg)\MEP_submission\2019-05-13 Turnover\K158 MEP-CAD\03_Plg\P061-P101.dwg 05/14/19 - 11:53am ashby